

Hexagonal bolt, with thread to head and fine thread DIN 961, steel 10.9, plain

Standards	DIN 961
Material	Steel
Property class	10.9
Surface	Plain
RoHS-compliant	Yes

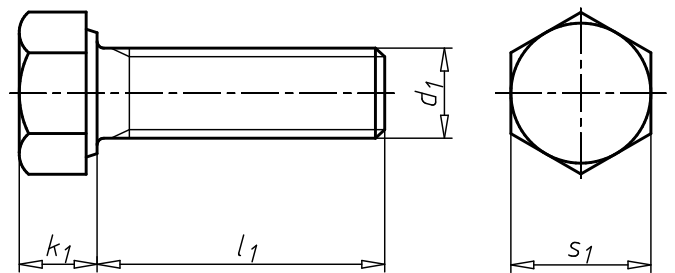

Thread type x nominal diameter x pitch (d ₁)	Length (l ₁)	Head height (k ₁)	External drive (s ₁)	Art. no.	P. Qty.
M8 x 1	35 mm	5.3 mm	WS13	0067 608 35	200
M8 x 1	40 mm	5.3 mm	WS13	0067 608 40	200
M8 x 1	50 mm	5.3 mm	WS13	0067 608 50	100
M10 x 1.25	20 mm	6.4 mm	WS17	0067 610 20	200
M10 x 1.25	30 mm	6.4 mm	WS17	0067 610 30	200
M10 x 1.25	35 mm	6.4 mm	WS17	0067 610 35	200
M10 x 1.25	55 mm	6.4 mm	WS17	0067 610 55	100
M10 x 1.25	60 mm	6.4 mm	WS17	0067 610 60	100
M12 x 1.25	20 mm	7.5 mm	WS19	0067 612 20	200
M12 x 1.5	25 mm	7.5 mm	WS19	0067 612 25	100
M12 x 1.5	30 mm	7.5 mm	WS19	0067 612 30	100
M12 x 1.5	35 mm	7.5 mm	WS19	0067 612 35	100
M12 x 1.5	40 mm	7.5 mm	WS19	0067 612 40	100
M12 x 1.5	45 mm	7.5 mm	WS19	0067 612 45	100
M12 x 1.5	50 mm	7.5 mm	WS19	0067 612 50	100
M12 x 1.5	55 mm	7.5 mm	WS19	0067 612 55	100
M12 x 1.5	60 mm	7.5 mm	WS19	0067 612 60	50
M12 x 1.5	80 mm	7.5 mm	WS19	0067 612 80	50
M12 x 1.5	120 mm	7.5 mm	WS19	0067 612 120	10
M12 x 1.5	150 mm	7.5 mm	WS19	0067 612 015	25
M14 x 1.5	25 mm	8.8 mm	WS22	0067 614 25	50
M14 x 1.5	30 mm	8.8 mm	WS22	0067 614 30	100
M14 x 1.5	35 mm	8.8 mm	WS22	0067 614 35	100
M14 x 1.5	40 mm	8.8 mm	WS22	0067 614 40	50
M14 x 1.5	45 mm	8.8 mm	WS22	0067 614 45	50
M14 x 1.5	50 mm	8.8 mm	WS22	0067 614 50	50
M14 x 1.5	55 mm	8.8 mm	WS22	0067 614 55	50
M14 x 1.5	60 mm	8.8 mm	WS22	0067 614 60	50
M14 x 1.5	65 mm	8.8 mm	WS22	0067 614 65	50
M14 x 1.5	70 mm	8.8 mm	WS22	0067 614 70	50

Thread type x nominal diameter x pitch (d ₁)	Length (l ₁)	Head height (k ₁)	External drive (s ₁)	Art. no.	P. Qty.
M14 x 1.5	180 mm	8.8 mm	WS22	0067 614 180	25
M16 x 1.5	20 mm	10 mm	WS24	0067 616 20	50
M16 x 1.5	30 mm	10 mm	WS24	0067 616 30	50
M16 x 1.5	35 mm	10 mm	WS24	0067 616 35	50
M16 x 1.5	40 mm	10 mm	WS24	0067 616 40	50
M16 x 1.5	45 mm	10 mm	WS24	0067 616 45	50
M16 x 1.5	50 mm	10 mm	WS24	0067 616 50	100
M16 x 1.5	55 mm	10 mm	WS24	0067 616 55	50
M16 x 1.5	65 mm	10 mm	WS24	0067 616 65	50
M16 x 1.5	70 mm	10 mm	WS24	0067 616 70	25
M16 x 1.5	80 mm	10 mm	WS24	0067 616 80	25
M16 x 1.5	90 mm	10 mm	WS24	0067 616 90	25
M16 x 1.5	100 mm	10 mm	WS24	0067 616 100	25
M16 x 1.5	120 mm	10 mm	WS24	0067 616 120	1
M18 x 1.5	35 mm	11.5 mm	WS27	0067 618 35	50
M18 x 1.5	40 mm	11.5 mm	WS27	0067 618 40	50
M18 x 1.5	45 mm	11.5 mm	WS27	0067 618 45	50
M18 x 1.5	50 mm	11.5 mm	WS27	0067 618 50	50
M18 x 1.5	55 mm	11.5 mm	WS27	0067 618 55	50
M18 x 1.5	60 mm	11.5 mm	WS27	0067 618 60	25
M18 x 1.5	70 mm	11.5 mm	WS27	0067 618 70	25
M18 x 1.5	80 mm	11.5 mm	WS27	0067 618 80	25
M18 x 1.5	90 mm	11.5 mm	WS27	0067 618 90	50
M20 x 1.5	30 mm	12.5 mm	WS30	0067 621 30	25
M20 x 1.5	35 mm	12.5 mm	WS30	0067 621 35	25
M20 x 1.5	40 mm	12.5 mm	WS30	0067 621 40	25
M20 x 1.5	45 mm	12.5 mm	WS30	0067 621 45	25
M20 x 1.5	50 mm	12.5 mm	WS30	0067 621 50	25
M20 x 1.5	55 mm	12.5 mm	WS30	0067 621 55	25
M20 x 1.5	60 mm	12.5 mm	WS30	0067 621 60	25
M20 x 1.5	65 mm	12.5 mm	WS30	0067 621 65	25
M20 x 1.5	70 mm	12.5 mm	WS30	0067 621 70	50
M20 x 1.5	75 mm	12.5 mm	WS30	0067 621 75	400
M20 x 1.5	100 mm	12.5 mm	WS30	0067 621 100	25
M20 x 1.5	110 mm	12.5 mm	WS30	0067 621 110	1
M22 x 1.5	40 mm	14 mm	WS32	0067 622 40	25
M22 x 1.5	50 mm	14 mm	WS36	0067 625 50	25
M22 x 1.5	55 mm	14 mm	WS32	0067 622 55	25
M22 x 1.5	80 mm	14 mm	WS32	0067 622 80	25
M22 x 1.5	90 mm	14 mm	WS32	0067 622 90	1
M24 x 1.5	45 mm	15 mm	WS36	0067 625 45	25
M24 x 1.5	55 mm	15 mm	WS36	0067 625 55	25
M24 x 1.5	60 mm	15 mm	WS36	0067 625 60	25
M24 x 1.5	70 mm	15 mm	WS36	0067 625 70	25
M24 x 1.5	80 mm	15 mm	WS36	0067 625 80	10
M24 x 1.5	180 mm	15 mm	WS36	0067 625 180	10
M24 x 1.5	200 mm	15 mm	WS36	0067 625 200	10
M27 x 2	75 mm	17 mm	WS41	0067 627 75	15
M27 x 2	110 mm	17 mm	WS41	0067 627 110	1
M30 x 2	45 mm	18.7 mm	WS46	0067 630 45	10
M30 x 2	70 mm	18.7 mm	WS46	0067 630 70	25
M30 x 2	90 mm	18.7 mm	WS46	0067 630 90	10
M30 x 2	95 mm	18.7 mm	WS46	0067 630 95	10
M30 x 2	100 mm	17 mm	WS46	0067 630 100	10

Thread type x nominal diameter x pitch (d ₁)	Length (l ₁)	Head height (k ₁)	External drive (s ₁)	Art. no.	P. Qty.
M30 x 2	110 mm	18.7 mm	WS46	0067 630 110	1
M30 x 2	140 mm	18.7 mm	WS46	0067 630 140	10
M30 x 2	150 mm	18.7 mm	WS46	0067 630 150	10
M30 x 2	170 mm	18.7 mm	WS46	0067 630 170	15
M36 x 3	60 mm	22.5 mm	WS55	0067 636 60	10
M36 x 3	70 mm	22.5 mm	WS55	0067 636 70	10
M36 x 3	90 mm	22.5 mm	WS55	0067 636 90	10
M36 x 3	150 mm	22.5 mm	WS55	0067 636 150	1
M36 x 3	160 mm	22.5 mm	WS55	0067 636 160	5
M36 x 3	190 mm	22.5 mm	WS55	0067 636 190	5
M39 x 3	220 mm	25 mm	WS60	0067 639 220	1
M42 x 3	100 mm	26 mm	WS65	0067 642 100	5
M42 x 3	150 mm	26 mm	WS65	0067 642 150	1
M42 x 3	210 mm	26 mm	WS65	0067 642 210	1
M42 x 3	220 mm	26 mm	WS65	0067 642 220	1
M48 x 3	160 mm	30 mm	WS75	0067 648 160	5

Details/Application



Notice

DIN 961 has been withdrawn and replaced by ISO 8676. There is some similarity (nominal dimensions extended | Width across flats changed for M10, M12, M14 and M22).